



2021 Calibre Design Awards - Nominated Projects

EDUCATION



California Institute of Technology Chen Neuroscience Research Building

Nominated by: SmithGroup
Affiliated Engineers
Hensel Phelps
Saiful Bouquet



Cal Poly Pomona Student Housing

Nominated by: HMC Architects
Bapko Metal, Inc.
Geometrik Manufacturing, Inc.
Sundt Construction
Tarkett



Icon Collective

Nominated by: IA Interior Architects
Catalyst Office
Kaufmann and Associates
LA Sound Panels



UCLA Anderson School of Management

Nominated by: Gensler
PCL Construction
Steelcase
Tangram
Waveguide

EVOLVING ADAPTATIONS



Gardenhouse

Nominated by: Rottet Studio
Gruen Associates
DCH Builders, Inc.
MAD Architects
Palisades Capital Partners LLC
The Agency



Swinerton Santa Ana / Orange County

Nominated by: Shimoda Design Group
Creative Space
Grimm & Chen
Steelcase
Tangram



Workplace as Laboratory – A Case Study at Our Los Angeles Headquarters

Nominated by: RIOS
Aaron Kai - Mural Artist
Big Ass Fans
Control Air Enterprises
Harold Jones
Reaume Richardson

HEALTH & WELLNESS



Cedars-Sinai Biomanufacturing Center (CBC)

Nominated by: HDR Architecture
AEI Engineers
Pivot Interiors
R&S Construction



Cedars-Sinai MAST Program

Nominated by: HDR Architecture
AEI Engineers
MDC Wallcovering
Pivot Interiors
R&S Construction



Dr. Barbara Sturm, Los Angeles

Nominated by: HUXHUX Design
F-AD
Ferrante Koberling
Francis Krahe Associates
Gruen Associates
Taylor Syfan



Fudge Family Birthing Suites - Hoag Hospital Irvine

Nominated by: Taylor Design
KPFF
MR Walls
Nelson HPS
Rabben/Herman Design
tk1sc



Lawrence J. Ellison Institute for Transformative Medicine of USC

Nominated by: RIOS
CRB
Oculus Light Studio
Sierra Pacific Constructors
Systems Source



Metagenics Personalized Lifestyle Medical Clinic (PLMC)

Nominated by: H. Hendy Associates
PeopleSpace
PLP SoCal
tk1sc
Turelk

HEALTH & WELLNESS



RUHS Medical and Surgical Center

Nominated by: Ware Malcomb

KPFF Consulting Engineers

Millie and Severson

tk1sc

Trammell Crow



The Samuel Oschin Cancer Center at Cedars-Sinai

Nominated by: HGA

ARUP

Degenkolb Engineers

Hathaway Dinwiddie Construction Company

HOSPITALITY



Interstellar

Nominated by: Omgivning
Base Collaborative
Global Construction Services, Inc.
Nous Engineering
Play Space Grnd
Russell Holland Engineering



Liberation Coffee House

Nominated by: ORA
Brisas Drapery
Pacific Office Interiors
Swinerton

ON THE BOARDS



Alteryx

Nominated by: Wolcott Architecture
ARUP
Gardiner & Theobald Inc.
KPRS Construction Services
Newson Brown Acoustics
The Sheridan Group



BEN - Brand Entertainment Network Los Angeles

Nominated by: NxT studio
California Lighting Sales
JTM Construction Group Inc.
OFG Inc.
Pinnacle Inc.
Simon S. Wong & Associates



BMG Music Los Angeles

Nominated by: NxT studio
Alfatech
California Lighting Sales
Howard Building Corporation
Watchdog



Collage Culinary Experience

Nominated by: IA Interior Architects
Coffman Engineers, Inc.
GMEP Engineers
Servco Builder



FivePoint Plaza Level

Nominated by: Gensler
Englekirk Structural Engineers
KGM Lighting
KPRS
tk1sc

ON THE BOARDS



McCarthy Building Companies

Nominated by: Gensler
ARC Engineering
Steelcase
Tangram



Museum for the Heart

Nominated by: OFFICEUNTITLED
Clune Construction Company
Leviathan
LPA
Plannet
Sound Image

PUBLIC & COMMUNITY SPACES



Biomed Realty Building Entry and Common Area

Nominated by: ID Studios, Inc.

GMBI

Swinerton



Los Angeles Union Station Passenger Concourse Expansion and Renovation

Nominated by: Architectural Resources Group

Los Angeles Metropolitan Transportation Authority (Metro)

Morlin Asset Management, LP

Muir-Chase Plumbing Co.

Structural Focus

Swinerton



Watt Plaza Lobby Renovation & Expansion

Nominated by: STUDIOS Architecture

Alfa Tech, Inc.

Brandow & Johnston Associates

Clune Construction Company

Hiram Banks Lighting Design

Saw & Associates

WORK SMALL



500 Brand

Nominated by: Wolcott Architecture
Erkel Greenfield and Associates
Granite Properties
Interscape Construction
Office Furniture Group



Doctor Multimedia

Nominated by: SmithGroup
Backs Construction
Harmon + Wayne Engineering
Hughes Marino
Think Office Interiors



International Post-Production Studio

Nominated by: NxT studio
California Lighting Sales
Parker Brown Inc.
Simon S. Wong & Associates
Valencia Technical Consulting
Watchdog



Kettner & Ash

Nominated by: Gensler
Divco West
LDG Landscape
Ocean West
Standard Vision



Preston Ventures

Nominated by: D Space Interiors
Brookhollow
DBaC Inc.
Systems Source

WORK SMALL

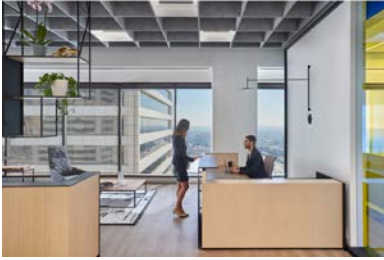

Spencer Stuart LA

Nominated by: Perkins&Will
HITT Construction
Watchdog



Topa Equities

Nominated by: Gensler
KGM Architectural Lighting
Swinerton
Western Office
WM Group West Engineers

WORK MEDIUM



Barnes & Thornburg San Diego

Nominated by: Gensler
Back's Construction
H+W Engineering
Martin & Libby Engineers



Branded Online

Nominated by: H. Hendy Associates
Brandow & Johnston
Crows Perspective
Savills
tk1sc
Turelk



CIGA

Nominated by: Wolcott Architecture
ALTA
CBRE
Office Furniture Group
Syska Hennessy



Fish & Richardson

Nominated by: ID Studios, Inc.
Hughes Marino
Pacific Building Group
Systems Source



J2 Global

Nominated by: Wolcott Architecture
AlfaTech
AM Cabinets
California Lighting Sales
Pinnacle Contracting Corp.
Tangram Interiors

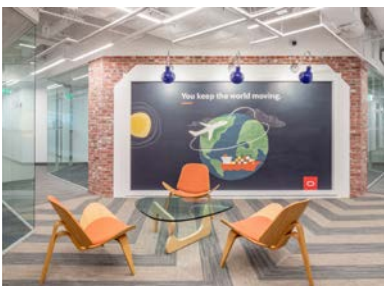

Oracle, 2425 Olympic Boulevard

Nominated by: AECOM
ARC Engineering
Bang Mac
Taslimi Construction

WORK MEDIUM



ORCI

Nominated by: Struere
Building Solutions Group - MEP Engineers
GCX LLC
Watchdog



Swinerton Office Downtown LA

Nominated by: Shimoda Design Group
Tangram
Steelcase

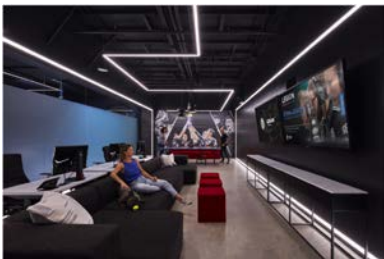

Team Solomid – TSM Performance Center

Nominated by: NxT Studio
JTM Construction Group
RTM Engineering
Cresa Los Angeles
California Lighting Sales



Traffik

Nominated by: LPA Design Studios
Bogart Construction
tk1sc
The Irvine Company

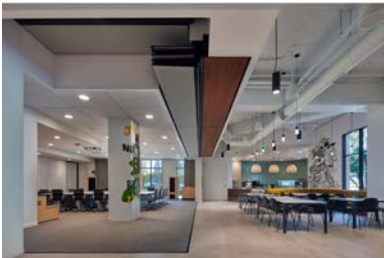

Universal Music Group

Nominated by: OKB
Corporate Contractors, Inc.
Krislyn Design
Western Office
ARC Engineering

WORK LARGE



CommonGrounds Workplace

Nominated by: Ware Malcomb

Arc Engineering
Clune Construction
CS Illumination Inc.
Cushman & Wakefield



Confidential Law Firm

Nominated by: Gensler

ARC Engineering
AWC Architectural Woodworking Company
PeopleSpace
Taslimi Construction
VVA Project & Cost Managers



FivePoint Corporate Office

Nominated by: Gensler

KPRS
Pivot Interiors
Taber Co.
tk1sc

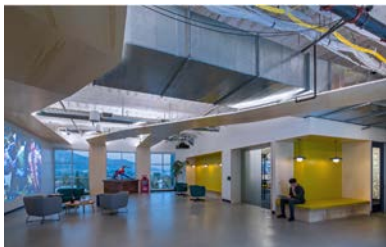

Insomniac Games

Nominated by: OKB

AMA Consulting Engineers
Environmental Contracting Corp.
Savills
Studio Other
Western Office



Rancho Los Amigos National Rehabilitation Center Support Services Building

Nominated by: Taylor Design

Department of Public Works, LA County
Interface
Kemp Bros. Construction, Inc.
Los Angeles County Dept. of Health Services
TTG-IMEG Corp.

WORK EXTRA LARGE



Confidential Client

Nominated by: ZGF
DPR Construction
Infrastructure Factor
Tangram Interiors



Confidential Law Firm

Nominated by: Gensler
ARC Engineering
PeopleSpace
The Sheridan Group
Taslimi Construction
VVA Project & Cost Managers



Epson

Nominated by: Wolcott Architecture
Adams CM
Howard Building Corporation
Pivot Interiors
Taber
tk1sc



GoodRx Headquarters

Nominated by: RIOS
AMA
ARC Engineering
Clune Construction
Holmes Structures

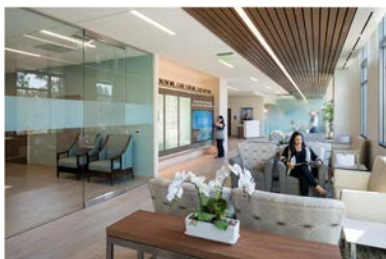

Providence St. Joseph Health Mission Hospital Leonard Cancer Institute

Nominated by: HKS Architects, Inc.
EXP
Miyamoto International Inc.
Montanio Design Group
Snyder Langston



Rutan & Tucker

Nominated by: Gensler
Cushman Wakefield
HBC
PeopleSpace
Systems Source
Trammell Crow

WORK EXTRA LARGE



Saatchi & Saatchi Los Angeles Office

Nominated by: Blitz
ARC Engineering
CRESA
Degenkolb Engineers
Fortyseven, LLC
HLB



TikTok

Nominated by: Gensler
Architecture & Light
Bytedance
Saiful Bouquet Structural Engineers
Swinerton
Western Allied